

# Quick-Lift Rail

QLR 600i

**Intelligent lifting device which meets the highest standards of ergonomics, working environment, safety and efficiency.**

Unique integrated mechanical, electrical, pneumatic swivel enables continuous rotation of end effector.

Powerful precision makes the Quick-Lift Rail 600i easy to use.

Exceptional safety is achieved using our intelligent control systems.

High cost efficiency through low power consumption, high reliability and long durability.



# Quick-Lift Rail

## QLR 600i

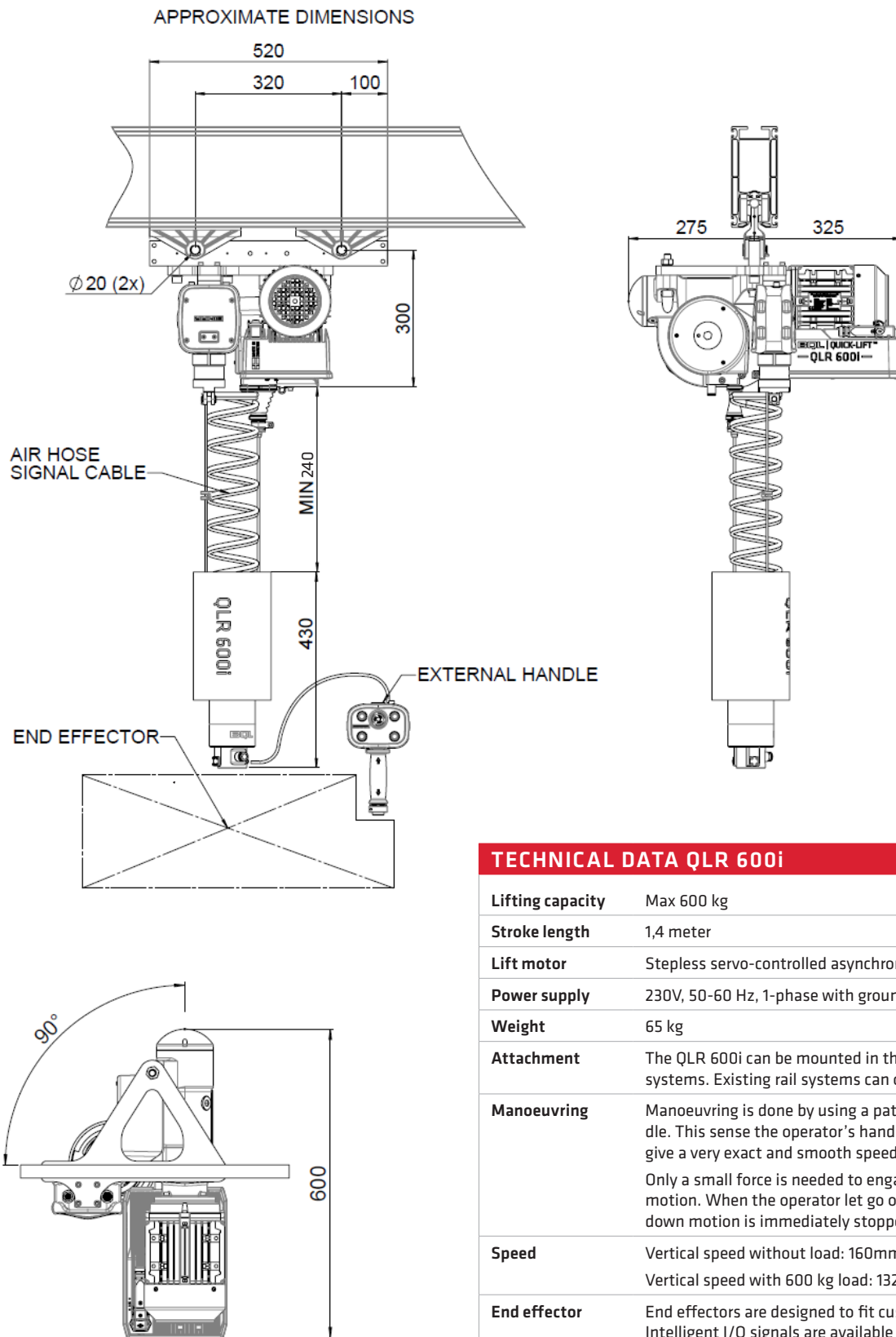

### TECHNICAL DATA QLR 600i

<b>Lifting capacity</b>	Max 600 kg
<b>Stroke length</b>	1,4 meter
<b>Lift motor</b>	Stepless servo-controlled asynchronous motor
<b>Power supply</b>	230V, 50-60 Hz, 1-phase with ground protection, 10A
<b>Weight</b>	65 kg
<b>Attachment</b>	The QLR 600i can be mounted in the most types of rail systems. Existing rail systems can often be used.
<b>Manoeuvring</b>	Manoeuvring is done by using a patented control handle. This sense the operator's hand/arm movement and give a very exact and smooth speed control. Only a small force is needed to engage the up/down motion. When the operator let go of the handle, the up/down motion is immediately stopped.
<b>Speed</b>	Vertical speed without load: 160mm/s Vertical speed with 600 kg load: 132mm/s
<b>End effector</b>	End effectors are designed to fit customers need. Intelligent I/O signals are available for optimum functionality

Binar Quick-Lift Systems AB disclaims responsibility for any errors or incomplete information in the published material and reserves the right to make changes.

#### Binar Quick-Lift Systems AB

Box 2014 • SE-461 11 TROLLHÄTTAN • Sweden  
 telephone: +46 (0)520 47 40 00 • e-mail: info.quicklift@binar.se  
 www.binarquicklift.com  
 2020-06-30 EN 1.1

**BINAR**  
*Improving your productivity*